

TOTAL EXTENT	:	20234 SQ.M
ROAD AREA	:	5757 SQ.M
PARK AREA (OSR)	:	1457 SQ.M
PUBLIC PURPOSE (I & II)	:	1528 SQ.M
REGULAR PLOTS (1 TO 62)	:	62 NOS
E.W.S. PLOTS (63 TO 88) 1457 SQ.M	:	26 NOS
TOTAL NO. OF PLOTS	:	88 NOS
COMMERCIAL	:	1 NO.

**NOTE:**

- SPLAY- 3.0M x 3.0M, 1.5M x 1.5M
- MEASUREMENTS ARE INDICATED EXCLUDING SPLAY DIMENSIONS

**CONDITIONS:**

- (I). DR RULE NO: 29 (8)  
 THE AREA EARMARKED FOR PUBLIC PURPOSE PLOTS I & II (VIZ. POST AND TELEGRAPH OFFICE, POLICE STATION ETC.) WOULD REMAIN RESERVED FOR A SPECIFIC PERIOD OF ONE YEAR FROM THE DATE OF APPROVAL TO ENABLE THE GOVERNMENT DEPT. CONCERNED TO NEGOTIATE WITH THE OWNER AND ACQUIRE THE RESERVED LAND IF REQUIRED FOR THEM. THE COST OF THE PLOT SHOULD NOT BE MORE THAN GUIDE LINE VALUE. IF THE PROMOTER ADDS PROPORTIONATE DEVELOPMENT COST ON THE PRICE OF THE PUBLIC PURPOSE PLOT, THE SAME SHOULD BE APPROVED BY CMDA.
- (II). DR RULE NO: 29 (9)  
 THE OWNER OR DEVELOPER OR PROMOTER SHALL SELL THE EWS PLOTS ONLY FOR EWS PURPOSE. NO CONVERSION OR AMALGAMATION SHALL BE PERMISSIBLE IN THE CASE OF EWS PLOTS.
- (IV). DR RULE NO: 29 (11)  
 THE COST OF LAYING IMPROVEMENTS TO THE SYSTEMS INRESPECT OF ROAD, WATER SUPPLY, SEWERAGE, DRAINAGE OR ELECTRIC POWER SUPPLY THAT MAY BE REQUIRED AS ASSESSED BY THE COMPETENT AUTHORITY, SHALL BE BORNE BY THE APPLICANT.
- (V). THE TNHB HAS TO HANDOVER ALL THE SCHEME ROADS AND THE PARK AREA TO THE COMMISSIONER, GREATER CHENNAI CORPORATION THROUGH REGISTERED GIFT DEED AS PER THE APPROVED LAYOUT PLAN, AFTER THE DEVELOPMENT WORKS ARE COMPLETED.
- (VI). TAMILNADU HOUSING BOARD IS RESPONSIBLE FOR THE SHAPE, SIZE & DIMENSIONS OF THE SITE UNDER REFERENCE.

**LEGEND:**

- SITE BOUNDARY
- PROPOSED ROAD
- EXISTING ROAD
- PARK (OSR)
- PUBLIC PURPOSE
- E.W.S.
- COMMERCIAL

**CONDITIONS:**

THE LAYOUT APPROVED IS VALID SUBJECT TO OBTAINING SANCTION FROM THE LOCAL BODY CONCERNED.

P.P.D (TNHB) NO: G-02  
 L.O 2017

APPROVED

VIDE LETTER NO : L2/19130/2016  
 DATE : 23/09/2017

*S. Senthil*  
 23/09/2017  
 FOR MEMBER SECRETARY  
 CHENNAI METROPOLITAN  
 DEVELOPMENT AUTHORITY

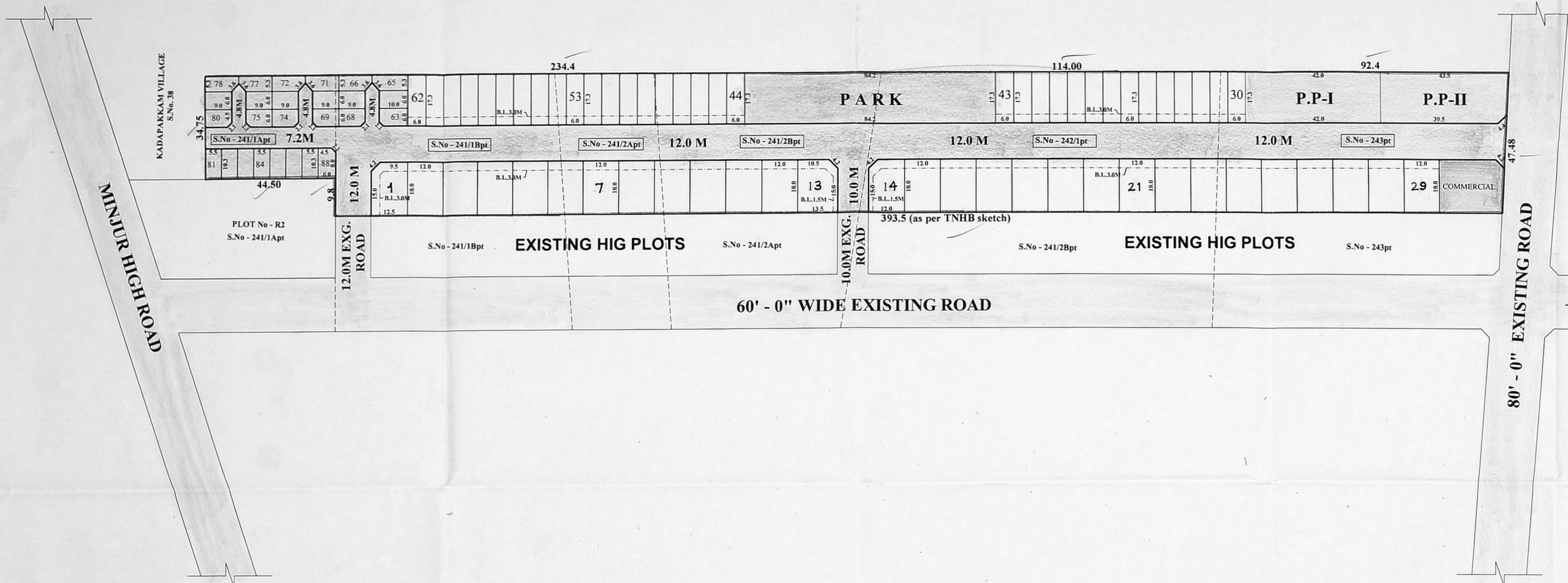

PREPARED BY P.A-IV (S.M) *[Signature]*  
 CHECKED BY P.A-I (S.R) *[Signature]*  
 A.P. (S.A) *[Signature]* 23/09/2017

# TAMILNADU HOUSING BOARD

## GREATER CHENNAI CORPORATION

PROPOSED LAYOUT OF HOUSE SITES IN S.Nos: 241/1Apt, 1Bpt, 2Apt, 2Bpt, 242/1pt & 243pt OF SADAYANKUPPAM VILLAGE.

SCALE : 1:800 (ALL MEASUREMENTS ARE IN METRE.)